



ドットコネクタ

Dot Connector

粒子配列技術を使った超低抵抗な新しいタイプの圧接型ゴムコネクタ
New Type of Elastic Connector with Ultra Low Electric Resistance.

超低抵抗の秘密

Secret of Super Low Resistance

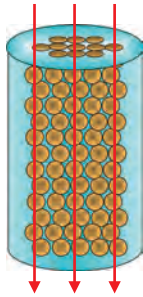

ドットコネクタ電極構造
Electrode Structure

粒子配向技術により、導電粒子を任意の場所に集約できる。
With the magnetic-oriented technology, the conductive fillers can be put together to any location.

柔軟な設計に対応

Flexible Custom Design Support



用途例 Applications

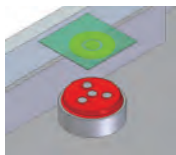

マイクホルダーコネクタ
Microphone Holder Connector

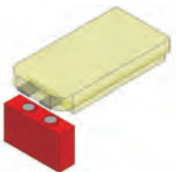

電子部品接続用
Elecroparts connector

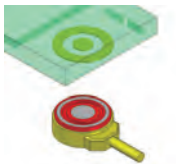

同軸コネクタ用
Co-axial connector

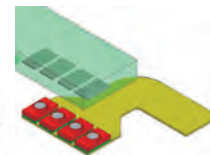
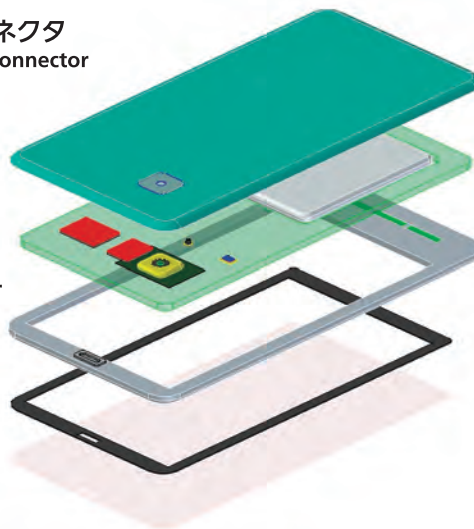

フィルムアンテナ用
Film antenna Connector

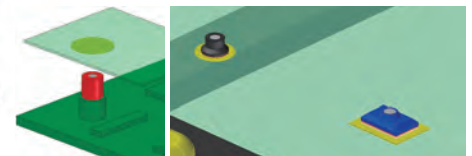

グラウンド用 (Pin-c / SMTDot / PSADot)
Ground

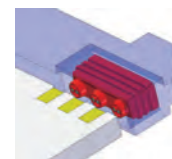

防水接続
Waterproof connector

特徴 Features

- 省スペース化 Save space
- 簡易組み立て Easy to assemble
- 低抵抗 Low electric resistance
- 自動実装対応 (リール梱包含む) Automatic Mounting available (Reed packing is included)
- 耐衝撃性 Shocking Resistance
- 低荷重 Low Stress Force



設計仕様 Design Support

H寸、ピッチ、接続極数、各種用途に合わせて最適な設計を行ないます。電極部以外の絶縁部形状は各種形状に対応できます。また異種材との一体化も可能です。

We bring Custom Design Support in Accordance with Height, Pitch and Electrode Numbers. Insulator Area also can be Customized, and Our Connector can be Embedded with Other Materials.

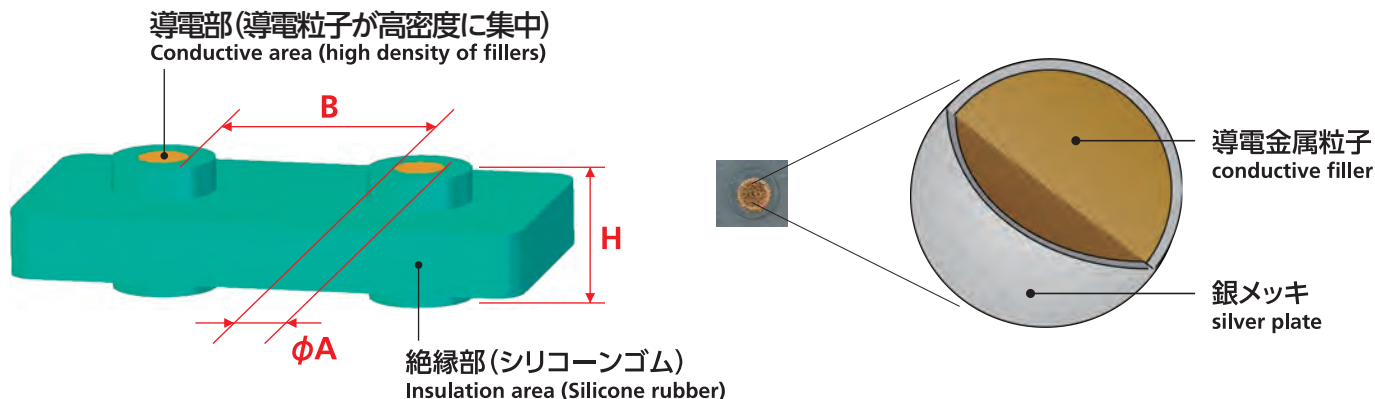

導電部径φA : 標準φ0.8mm (MINφ0.4mm) Contact φA : standard φ0.8mm (MIN φ0.4mm)

| Pith and H | Resistance (1pin) | Current capacity (1pin) | Force (1pin) | Completion ratio |
|-----------------------|-------------------|-------------------------|--------------|------------------|
| H < 1mm B > 0.5mm | 20mΩ | 10A | 1~5N | 20%~40% |
| 1 < H < 2mm B > 1mm | 40mΩ | 6A | 1~4N | 20%~35% |
| 2 < H < 3mm B > 1.5mm | 60mΩ | 4A | 1~3N | 20%~35% |
| 3 < H < 4mm B > 2.5mm | 80mΩ | 3A | 1~3N | 15%~25% |
| 4 < H < 5mm B > 3.5mm | 100mΩ | 2.5A | 1~2N | 10%~20% |

※設計仕様の範囲外のものについても、検討いたしますので、ご相談ください。

The specification out side the normal scope can be reviewed, therefore any proposition is welcomed.

特性例 Characteristic

